

**CONCRETE FOOTPAVING: TYPICAL FOOTWAY SECTION
TYPE A**

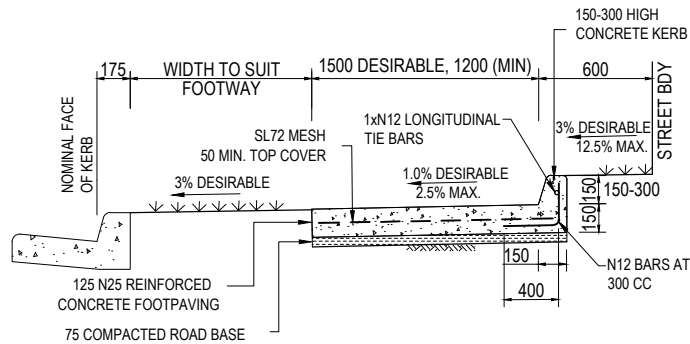

**CONCRETE FOOTPAVING WITH KERB: TYPICAL FOOTWAY SECTION
TYPE B**

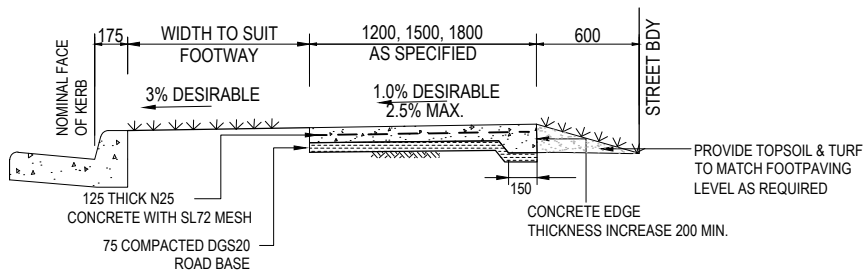

**CONCRETE FOOTPAVING WITH EDGE THICKENING: TYPICAL FOOTWAY SECTION
TYPE C**

NOTES:

1. FOOTPAVING WIDTH TO BE 1200, 1500, OR 1800 AS SPECIFIED. PROVIDE WIDER WIDTHS IN HIGH PEDESTRIAN VOLUME AREAS WITH 1800 DESIRABLE TO ALLOW 2 WHEELCHAIRS TO PASS.
2. FOR 1200 AND 1500 WIDTHS THE BACK EDGE OF FOOTPAVING TO BE ALIGNED GENERALLY 600 FROM STREET BOUNDARY. 1800 WIDTH FOOTPAVING TO BE ALIGNED WITH STREET BOUNDARY.
3. FOOTPAVING CROSSFALL 1.0% DESIRABLE TO 2.5% MAX IS TO BE PROVIDED.
4. FOOTPAVING TO BE A CONSTANT HEIGHT ABOVE THE TOP OF KERB WHERE POSSIBLE, EXCEPT AT LANDINGS. TRANSITIONS IN GRADE TO MATCH EXISTING VEHICULAR FOOTWAY CROSSINGS (VFCs) ARE NOT TO EXCEED A GRADE OF 1 IN 14 TO COMPLY WITH AS 1428.1.
5. PROVIDE LANDINGS 1200 LONG WITH LONGITUDINAL GRADIENT LESS THAN 2.5% [1:40] WHERE THE PATH GRADIENT EXCEEDS 4% [1:33]. LANDING INTERVALS SHOULD NOT EXCEED 25M FOR 4% GRADIENT REDUCING TO 15M FOR 5% GRADIENT AND 9M FOR 7.1% [1:14] GRADIENT.
6. FOOTPAVING ACROSS VEHICULAR ENTRANCES SHALL BE INCREASED IN THICKNESS AND REINFORCED AS SPECIFIED IN ACCORDANCE WITH CROSSING TYPE AND VEHICULAR MOVEMENTS. RESTORE ANY ADJOINING UNMADE VEHICULAR CROSSING WITH COMPACTED ROAD BASE FINISHED TO EVENLY MATCH THE FOOTPAVING.
7. CONCRETE IS TO BE STRENGTH GRADE N25, 20 MAX SIZE AGGREGATE, IN ACCORDANCE WITH AS3600.
8. ROAD BASE IS TO BE CRUSHED ROCK OR CRUSHED CONCRETE GRADED TO DGS20 COMPACTED TO NOT LESS THAN 98% STANDARD MAXIMUM DRY DENSITY TO AS1289.
9. SOFT SUBGRADE IS TO BE REMOVED AND REPLACED WITH DGS20 ROAD BASE ON GEOCOMPOSITE LAYER AS REQUIRED AND COMPACTED TO 95% STANDARD MAXIMUM DRY DENSITY.
10. CONCRETE FOOTPAVING ISOLATION JOINTS SHALL BE PREFORMED BITUMEN IMPREGNATE FIBREBOARD 10 WIDE, FULL CONCRETE DEPTH AT NO MORE THAN 6000 SPACING.
11. CONCRETE DUMMY JOINTS TO BE PROVIDED 10 DEEP, 10 WIDE AT 1200 SPACING WITH APPROVED GROOVING TOOL. SETOUT OF DUMMY JOINTS TO BE SQUARE TO SIDES. ON CURVES DUMMY JOINTS TO BE AT 1200 SPACING ALONG CENTRELINE.
12. PROVIDE ISOLATION JOINTS ADJOINING HARD SURFACES AND AROUND ALL STRUCTURES IN CONCRETE PAVING USING PREFORMED BITUMEN IMPREGNATED FIBREBOARD 10 WIDE. CORNERS TO BE REINFORCED WITH 2xN12 STEEL BARS 400 LONG AS SHOWN IN DETAIL.
13. CONCRETE SURFACES TO BE FINISHED WITH A MEDIUM BROOM AT 90° TO DIRECTION OF PEDESTRIAN TRAVEL, AND EDGES TO BE ROUNDED TO 20 RADIUS USING A 50 WIDE BULLNOSE EDGING TROWEL.
14. PROVIDE 600 x 600 MIN SPLAYS AT FOOTPAVING INTERNAL CORNERS INCLUDING FOOTPAVING CONNECTIONS TO KERB RAMPS AND BUS STOPS.
15. ADJOINING NATURAL FOOTWAY IS TO BE CUT OR FILLED WITH TOPSOIL AS REQUIRED TO GRADE EVENLY TO THE FOOTPAVING. ALL DISTURBED AREAS ARE TO BE TURFED, OR REINSTATED AS DIRECTED BY COUNCIL.
16. MAINTAIN 600 CLEAR WIDTH TO VEGETATION AND SIGNS ON VERGES ON BOTH SIDES OF THE FOOTPAVING. MAINTAIN OVERHEAD CLEARANCES OF 2500 TO VEGETATION AND 2100 TO SIGNS.
17. FOOTPAVING ADJOINING STREET TREES IS TO BE CONSTRUCTED IN ACCORDANCE WITH CBC STD DWG S-209 AND S-210.
18. FOOTPAVING IS TO MATCH EXISTING VEHICULAR CROSSINGS UNLESS SPECIFIED OTHERWISE.
19. REFER TO CBC STD DWG S-031 FOR REQUIREMENTS FOR STRUCTURES IN THE PAVING SUCH AS PUBLIC UTILITY PITS, POWER POLES.
20. CONCRETE INFILL COVERS TO BE CAST IRON MASCOT CLASS B OR APPROVED EQUIVALENT.

ALL DIMENSIONS ARE IN MILLIMETRES UNLESS NOTED OTHERWISE



CITY OF CANTERBURY BANKSTOWN		STD DWG N°
STANDARD FOOTPAVING RESIDENTIAL FOOTWAYS		S-027
Sheet N°: 1 of 1	Revision: 9/02/2026	
SECTIONS AND GENERAL NOTES		File Name: S-027.dwg