

U:\Standard Drawings\Standard Drawings - Draft\Brand.LO.CO.Update\S-021.dwg 10/02/2026 3:40:54 PM

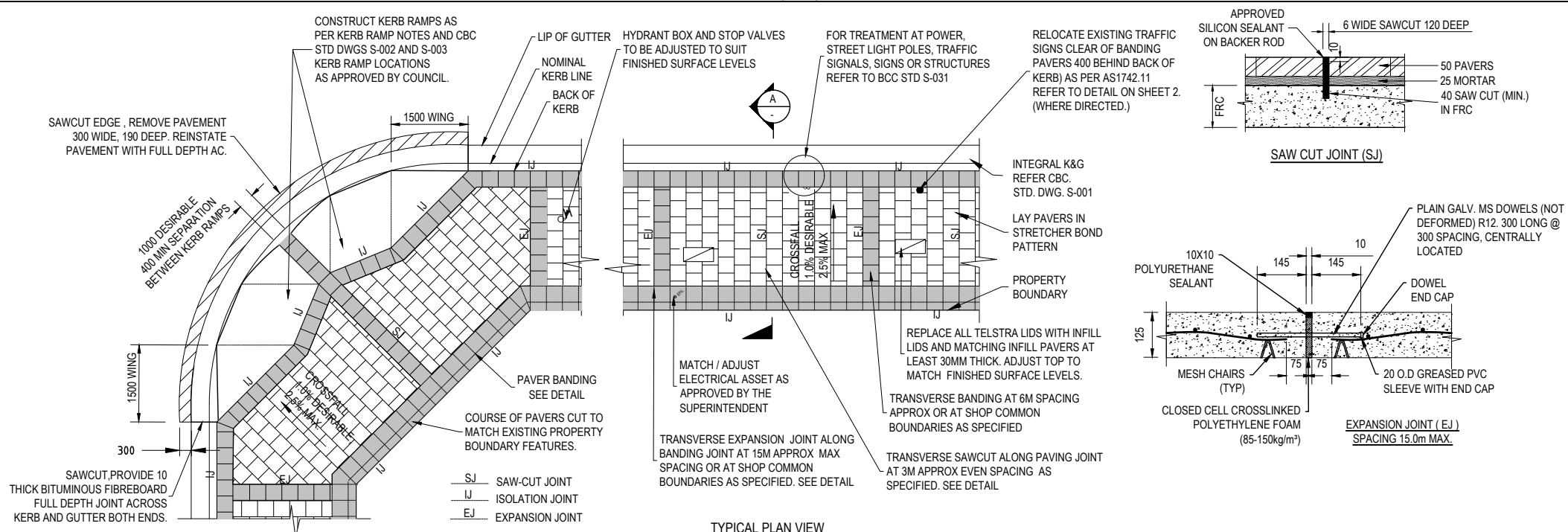

TYPICAL PLAN VIEW

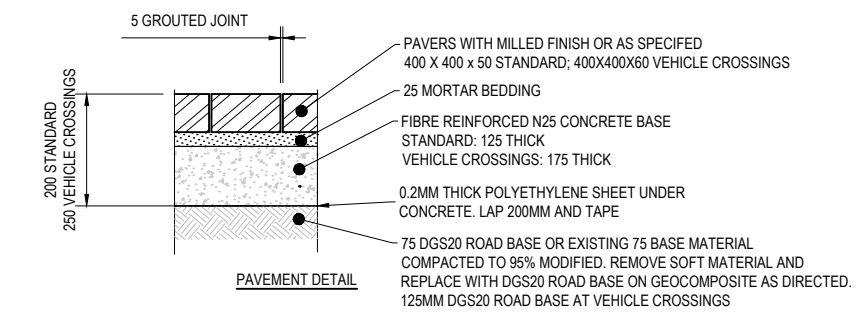
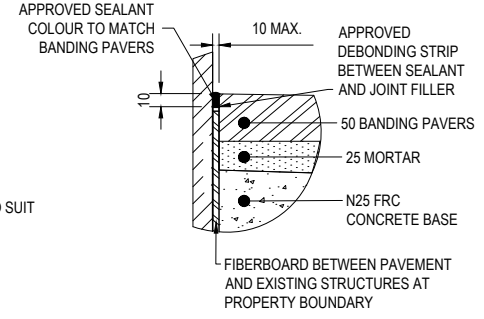
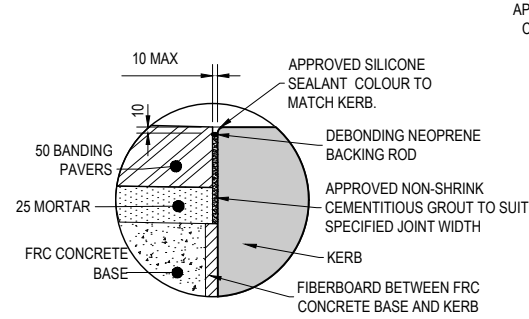
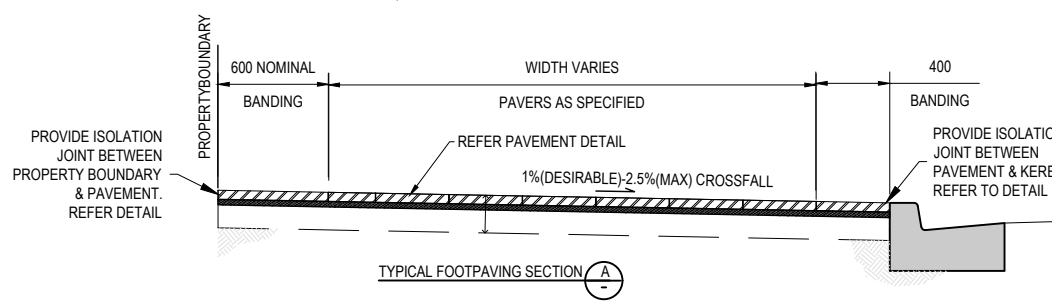

ALL DIMENSIONS ARE IN MILLIMETRES UNLESS NOTED OTHERWISE



CITY OF CANTERBURY BANKSTOWN		STD DWG N°
STANDARD FOOTPAVING: TYPE 1		S-021
PAVERS WITH BANDING: FULL WIDTH		Sheet N°: 1 of 2
		Revision: 11/02/2026
TOWN CENTRE PAVING		File Name: S-021

GENERAL

- G1. A SITE SPECIFIC DESIGN IS TO BE PREPARED AND APPROVED BY COUNCIL PRIOR TO CONSTRUCTION.
THE PLAN IS TO DETAIL KERB RAMP SETOUT, BANDING PATTERN, JOINT DETAILS AND TREATMENT TO EXISTING STRUCTURES.
- G2. TRANSVERSE PAVER BEDS TO BE PROVIDED AT EVEN SPACING OF ABOUT 12m MAX. OR AS SPECIFIED BY COUNCIL.
- G3. TREE PLANTING BEDS ARE TO BE PROVIDED FOR ALL EXISTING TREES TO BE RETAINED.
NEW TREE PLANTING BEDS ARE TO BE PROVIDED AT 8.0m TO 10.0m SPACING OR AT LOCATIONS APPROVED BY COUNCIL.
ALL TREE BEDS ARE TO BE CONSTRUCTED TO DETAILS ON COUNCIL STANDARD.
THE BANDING PATTERN IS TO INCORPORATE TREE BED BANDING AS COUNCIL STANDARD.

SERVICES

- S1. A FIELD CHECK FOR ALL EXISTING CABLES/ CONDUITS SHALL BE CARRIED OUT PRIOR TO COMMENCEMENT OF ANY WORK WITH A QUALIFIED CABLE LOCATOR
- S3. ALL UTILITY FEATURES, e.g. STOP VALVE COVERS, HYDRANTS, TELECOMMUNICATION PITS, SHALL BE ADJUSTED TO SUIT FINISHED SURFACE
- S4. TELECOMMUNICATION PIT COVERS SHALL BE TELSTRA APPROVED INFILL TYPE COVERS UNLESS NOTED OTHERWISE. INFILL PAVERS TO BE USED ACROSS BANDING, UTILITY & SERVICES PITS COVERS.
- S5. APPROVED UTILITY ACCREDITED SUBCONTRACTORS SHALL BE USED FOR ADJUSTING ANY SERVICE.
- S6. FOR SHALLOW LOCAL TELECOMMUNICATION CABLES WHERE APPROVED BY THE SUPERINTENDENT THE CONCRETE BASE THICKNESS MAY BE REDUCED BUT NOT LESS THAN 75mm THICK OVER A MAXIMUM WIDTH OF 300mm.

TGSI AND KERB RAMP NOTES:

- KR1. WHERE SPECIFIED TACTILE GROUND SURFACE INDICATORS (TGSI) SHALL BE INSTALLED IN ACCORDANCE WITH APPROVED PLAN COMPLYING WITH AS/NZS1428.4 AND CBC STANDARD DRAWING S-002.
- KR2. QUALITY CONTROL SAMPLES (MIN. 3 OF EACH UNIT) OF BOTH WARNING AND INDICATOR TGSI TO BE USED SHALL BE SUBMITTED TO COUNCIL FOR APPROVAL.
- KR3. TGSI TO BE TILES OF SIZE, TYPE, COLOUR AND LUMINOUS REFLECTANCE VALUE AS SPECIFIED BY COUNCIL. TGSI ARE TO HAVE LUMINANCE CONTRAST OF MORE THAN 30% TO THE SURROUNDING SURFACE. FOR WET AND DRY CONDITIONS AND ALLOWING FOR CHANGE OF COLOUR DUE TO AGEING.
- KR4. KERB RAMPS TO BE CONSTRUCTED IN ACCORDANCE WITH BCC STD DWG S-003. EXISTING KERB & GUTTER TO BE REMOVED AND GUTTER, KERB, RAMP, AND WINGS OF THE KERB RAMP SHALL BE CAST MONOTHICALLY IN PLAIN GREY CONCRETE TO MATCH ADJOINING KERB & GUTTER.
- KR5. KERB RAMP TO BE ALIGNED WITH THE DESIRED DIRECTION OF PEDESTRIAN TRAVEL, USUALLY PARALLEL WITH THE PROPERTY BOUNDARY, SUBJECT TO SITE SPECIFIC CONSTRAINTS.
- KR6. CONCRETE SHALL HAVE STRENGTH GRADE N25 IN ACCORDANCE WITH AS1379.
- KR7. ROAD BASE WHERE REQUIRED UNDER THE KERB RAMP AND GUTTER TO BE CRUSHED ROCK OR CRUSHED RECYCLED CONCRETE GRADED TO DGS20, COMPACTION TO BE 98% MODIFIED.
- KR8. ROAD PAVEMENT 300mm WIDE ADJOINING NEW GUTTER TO BE REMOVED TO 190mm DEPTH. PAVEMENT IS TO BE REINSTATED USING FULL DEPTH AC. WEARING SURFACE TO BE AC10 40mm THICK. BASE AC TO BE AC20 IN 2 LAYERS, OR APPROVED EQUIVALENT.
- KR9. PLAIN CONCRETE SURFACES ARE TO BE BROOM FINISHED ACROSS THE DIRECTION OF PEDESTRIAN TRAVEL

ALL DIMENSIONS ARE IN MILLIMETRES UNLESS NOTED OTHERWISE

UNIT PAVING FOR ALL AREAS:

- P1. PAVING SHALL BE GRANITE OR CONCRETE AS SPECIFIED.
DIMENSIONS: 400x400x50 STANDARD
400x400x60 VEHICLE CROSSINGS
GRANITE PAVING: COLOUR & FINISH: AS SPECIFIED.
CONCRETE PAVING:
COLOUR: BANDING: ESTUARY GREY OR AS SPECIFIED
BODY: GOLDEN GUNMETAL OR AS SPECIFIED
FINISH: MILLED.
- P2. MILLED PAVER UNITS FINISH SHALL BE HONED AND LIGHTLY SHOT
BLASTED WITH CLASS W SLIP RESISTANCE CLASSIFICATION ACCORDING TO THE WET PENDULUM TEST TO AS/NZS 4586, BOTH UNSEALED AND SEALED OR AS DIRECTED BY COUNCIL.
- P3. THE PAVER UNITS SHALL HAVE GROUDED JOINTS OF 5mm WIDTH. THE GROUT UNLESS NOTED OTHERWISE SHALL BE AN APPROVED NON-SHRINK CEMENTITIOUS GROUT TO SUIT GAPS OF 5mm WIDTH OR LESS.
- P4. (i) THE INTERFACE BETWEEN THE FLAGS AND THE MORTAR BEDDING SHALL HAVE A CONCRETE BONDING SLURRY OF (BY VOLUME) 1 PART WASHED SAND: 6 PARTS PORTLAND TYPE GP CEMENT AND SUFFICIENT WATER TO ACHIEVE A UNIFORM WORKABLE CONSISTENCY.
(ii) 25mm THICK MORTAR BED SHALL CONSIST OF (BY VOLUME) 1 PART WASHED SAND: 3 PARTS PORTLAND TYPE GP CEMENT MIXED WITH AN APPROVED ELASTICISER.
- P5. THE CONCRETE BASE SHALL CONSIST OF STRENGTH GRADE N25 CONCRETE WITH POLYPROPYLENE, COLLATED, FIBRILLATED FIBRES OF MINIMUM 19mm LENGTH ADDED TO THE CONCRETE AT THE RATE OF 0.9kg/m³ OF CONCRETE. THESE FIBRES SHALL BE UNIFORMLY MIXED THROUGH THE CONCRETE, ENSURING PROPER SEPARATION AND DISTRIBUTION PRIOR TO PLACEMENT OF THE CONCRETE.
- P6. APPLY A HEAVY BROOM FINISH PARALLEL TO THE FALL OF THE CONCRETE BASE SURFACE FOR DRAINAGE AND BONDING.
- P7. ALONG PROPERTY BOUNDARY LAY 1 COURSE FULL PAVERS PARALLEL TO KERB & FILL TO PROPERTY LINE WITH CUT PAVERS. MINIMUM WIDTH OF CUT PAVER 1/2 WIDTH OF FULL PAVER.
- P8. FULL DEPTH ISOLATION JOINTS SHALL BE INSTALLED WHERE PAVEMENT ABUTS SOLID STRUCTURES SUCH AS AT PROPERTY BOUNDARY, PUBLIC UTILITY STRUCTURES, KERB AND GUTTER. SEE EXPANSION JOINT DETAIL AND ISOLATION JOINT DETAIL.
- P9. PROVIDE ISOLATION JOINTS AT 15m MAXIMUM SPACING ACROSS FOOTPAVING. THE JOINTS ARE TO BE LOCATED ALONG THE EDGE OF A TRANSVERSE PAVER BAND.
- P10. PROVIDE SAW-CUT JOINTS IN CONCRETE BASE TO ALIGN WITH PAVER JOINTS AND TO BE EVENLY SPACED AT APPROX 3000mm ACROSS FOOTPAVING. SEE SAW CUT JOINT DETAIL.
- P11. ALL PAVERS SHALL BE SEALED IN-SITU TO PROTECT AGAINST STAINING DURING CONSTRUCTION.
- P12. PAVER INFILL COVERS TO BE CAST IRON MASCOT CLASS B OR APPROVED EQUIVALENT. USE 30MM THICK PAVERS CUT TO SHAPE AS INFILL.

SUB SOIL DRAINAGE

- SSD1. SUBSOIL DRAINAGE SHALL BE PROVIDED IN ACCORDANCE WITH B.C.C STANDARD DRAWING S-116. SUBSOIL DRAINAGE IS TO BE CONNECTED TO EXISTING STORMWATER DRAINAGE SYSTEM. CLEANOUTS ARE TO BE PROVIDED AT THE COMMENCEMENT OF THE SUBSOIL DRAINAGE AND EVERY 60m OR AS DIRECTED BY THE SUPERINTENDENT.
- SSD2. SUBSOIL DRAINAGE PIPE SHALL BE Ø100mm TYPE 1, CLASS 1000 SLOTTED PLASTIC CIRCULAR PIPE AND SHALL BE FITTED WITH A FILTER SOCK. BOTH THE SUBSOIL DRAINAGE PIPE AND THE FILTER SOCK SHALL COMPLY WITH AUS-SPEC 2
- SSD3. SUBSOIL DRAINAGE TO BE PLACED IN ACCORDANCE WITH AUS-SPEC 2 WITH FILTER MATERIAL TO BE TYPE 'A' USING 5mm CRUSHED RECYCLED CONCRETE. GEOTEXTILE TRENCH LINER (BIDUM A14 OR APPROVED EQUAL) TO BE PROVIDED AROUND TYPE A FILTER MATERIAL. PROVIDE LAPS OF 500mm AT FABRIC JOINTS

KERB AND GUTTER

- K1. NEW KERB AND GUTTER SHALL BE IN ACCORDANCE WITH CBC STD DWG S-001.

BUS STOPS

- BS1 FOR BUS STOP SETOUTS REFER CBC STANDARD DWGS S-017(A), S-018(A) OR S-019(A).

TRAFFIC SIGNAGE

- TS1. ALL Ø60 OD TRAFFIC SIGN POSTS REQUIRING INSTALLATION OR RELOCATION WITHIN AREAS OF CONCRETE OR PAVERS SHALL BE FIXED VERTICALLY USING AN AUTOMATIC POST SECURING DEVICE EQUAL TO 'KDC SYSTEMS' "POST LOCK SYSTEM". UNLESS NOTED OTHERWISE, THESE DEVICES SHALL BE INSTALLED USING A STANDARD 350mm UNIT IN ACCORDANCE WITH THE MANUFACTURER'S REQUIREMENTS. THESE DEVICES CAN BE OBTAINED FROM EITHER: GRIBBLE & BRENNAN PTY. LTD, 8 ROWOOD RD, PROSPECT, 2148 PH: 9688 3255 OR HVS SERVICES, 31 WARREN AV, BANKSTOWN, PH: 9792 4799, FAX 9790 6799
- TS2. ALL TRAFFIC SIGN POSTS TO BE LOCATED CLEAR OF BANDING PAVERS.
- TS3. INSTALL SIGN POSTS AS PER S-351
- TS4. EXISTING SIGNS OF A CONFLICTING NATURE SHALL BE COVERED TO COUNCILS SATISFACTION DURING THE CONSTRUCTION PERIOD

STREET TREE PLANTING

- STP1. NEW TREE PLANTING AS SPECIFIED BY COUNCIL. BCC STANDARD DRAWING S-207 AND S-207A APPLY. EXISTING TREES TO BE RETAINED AND PROTECTED UNLESS OTHERWISE SPECIFIED BY COUNCIL. BCC STANDARD DRAWING S-209 AND S-210 APPLY.

FOOTPAVING TREATMENT FOR STRUCTURES:

- FIXT1. FOOTPAVING TREATMENT FOR STRUCTURES AS SPECIFIED BY COUNCIL AND AS DETAILED ON CBC STANDARD DRAWING S-031.



CITY OF CANTERBURY BANKSTOWN		STD DWG N°	
STANDARD FOOTPAVING: TYPE 1 PAVERS WITH BANDING: FULL WIDTH		S-021	
		Sheet N°: 2 of 2	Revision: 11/02/2026
TOWN CENTRE PAVING		File Name: S-021	